

THINSHEET NUT CLOSED END

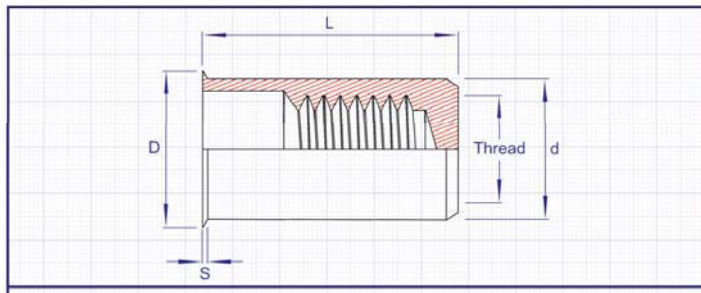

visit: www.npfasteners.com/tsb-steel.shtml



**TYPE
TSB**

SPECIFICATION

*SUBJECT TO AVAILABILITY

Thread & Pitch	Grip Range	Hole Size + 0.1 - 0.0	D	d	S	L
M3 x 0.5*	11 (0.5 - 1.1)	5.0	5.8	5.0	0.3	11.7
	23 (1.0 - 2.3)					12.9
M4 x 0.7	13 (0.5 - 1.3)	6.0	6.8	6.0	0.3	15.1
	30 (1.0 - 3.0)					16.8
M5 x 0.8	15 (0.5 - 1.5)	7.0	8.0	7.0	0.4	16.8
	35 (1.0 - 3.5)					19.3
M6 x 1.0	15 (0.5 - 1.5)	9.0	10.0	9.0	0.4	21.3
	35 (1.0 - 3.5)					23.3
M8 x 1.25	18 (0.5 - 1.8)	11.0	12.0	11.0	0.4	24.0
	50 (1.5 - 5.0)					27.8
M10 x 1.5	32 (0.5 - 3.2)	13.0	14.4	13.0	0.5	32.0
	50 (1.5 - 5.5)					34.4

INFORMATION

MATERIALS

Mild Steel (Stainless Steel To Special Order), (Aluminium To Special Order).

FINISHES

Zinc Trivalent Passivate (SZ).

PART NUMBER EXAMPLE

Type / Thread / Grip Range / Finish =

TSB - M5 - 35 - SZ

(Thinsheet Closed End, M5, 1.0 to 3.5mm Panel, Steel, Zinc)

SHEET NUT INSTALLATION GUIDE

